

Existing rafters to be upgraded for new span & doubled up as necessary in accordance with engineers details.

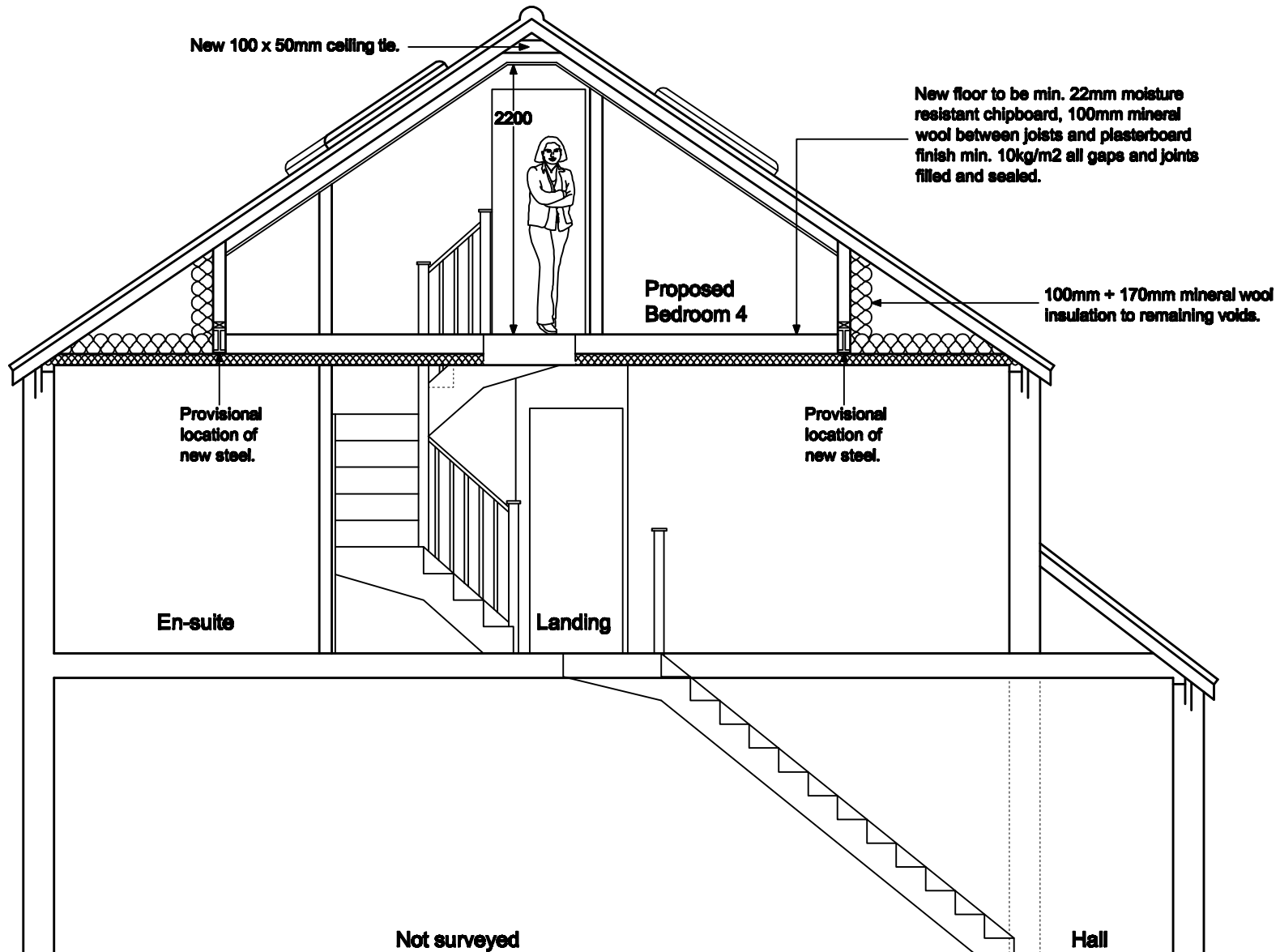

New 100 x 50mm ceiling tie.

2200

New floor to be min. 22mm moisture resistant chipboard, 100mm mineral wool between joists and plasterboard finish min. 10kg/m2 all gaps and joints filled and sealed.

Proposed Bedroom 4

100mm + 170mm mineral wool insulation to remaining voids.

Provisional location of new steel.

Provisional location of new steel.

En-suite

Landing

Not surveyed

Hall